

| CUADRO DE PERFILES DE TORRE (h=18m) |             |              |            |
|-------------------------------------|-------------|--------------|------------|
| PANEL                               | MONTANTE    | DIAGONAL     | HORIZONTAL |
| PANEL 1                             | Tub.Ø2"     | L 1.1/2x1/8" | L 2x3/16"  |
| PANEL 2                             | Tub.Ø2"     | L 1.1/2x1/8" | L 2x3/16"  |
| PANEL 3                             | Tub.Ø2"     | L 1.1/2x1/8" | L 2x3/16"  |
| PANEL 4                             | Tub.Ø2.1/2" | L 2x3/16"    | L 2x3/16"  |
| PANEL 5                             | Tub.Ø2.1/2" | L 2x3/16"    | L 2x3/16"  |
| PANEL 6                             | Tub.Ø2.1/2" | L 2x3/16"    | L 2x3/16"  |
| PANEL 7                             | Tub.Ø2.1/2" | L 2x3/16"    | L 2x3/16"  |
| PANEL 8                             | Tub.Ø3"     | L 2x3/16"    | L 2x3/16"  |
| PANEL 9                             | Tub.Ø3"     | L 2x3/16"    | L 2x3/16"  |
| PANEL 10                            | Tub.Ø3"     | L 2x3/16"    | L 2x3/16"  |
| PANEL 11                            | Tub.Ø3"     | ----         | ----       |

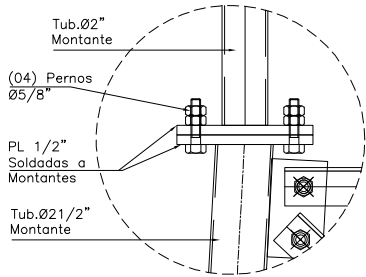

DETALLE "1"  
CONEXION ENTRE MONTANTES  
ESC 1:10

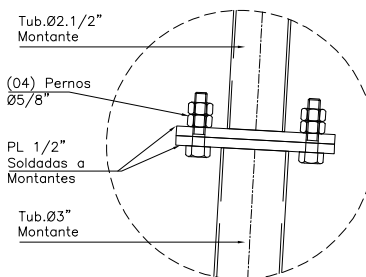

DETALLE "3"  
CONEXION ENTRE MONTANTES  
ESC 1:10

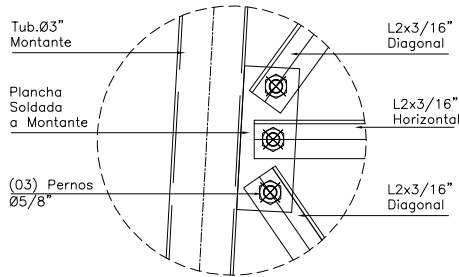

DETALLE "4"  
ESC 1:10

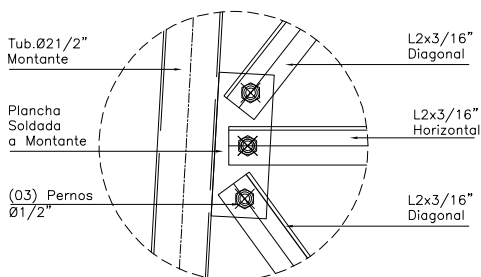

DETALLE "2"  
ESC 1:10

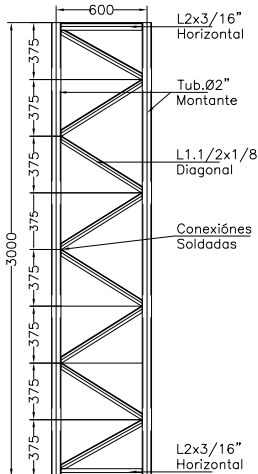

PANEL 1-2  
ESC 1:50

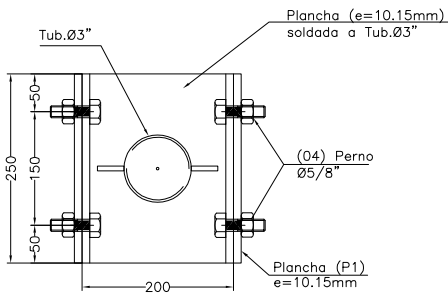

VISTA DE PLANTA

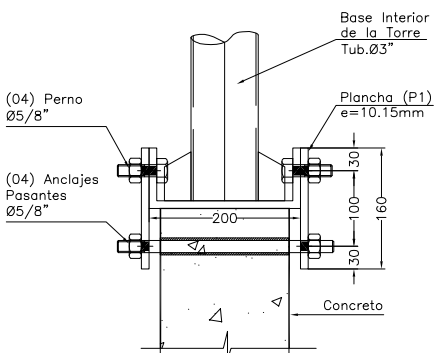

VISTA DE ELEVACIÓN

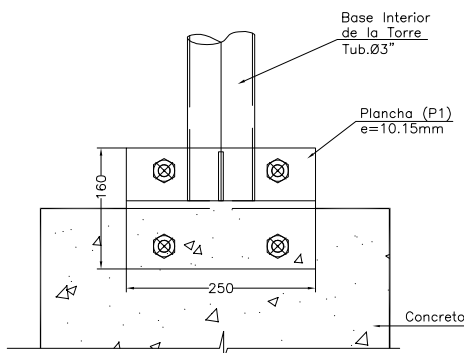

VISTA DE LATERAL

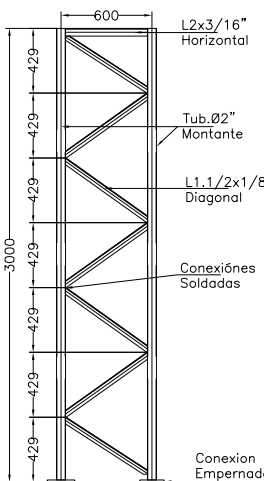

PANEL 3  
ESC 1:50

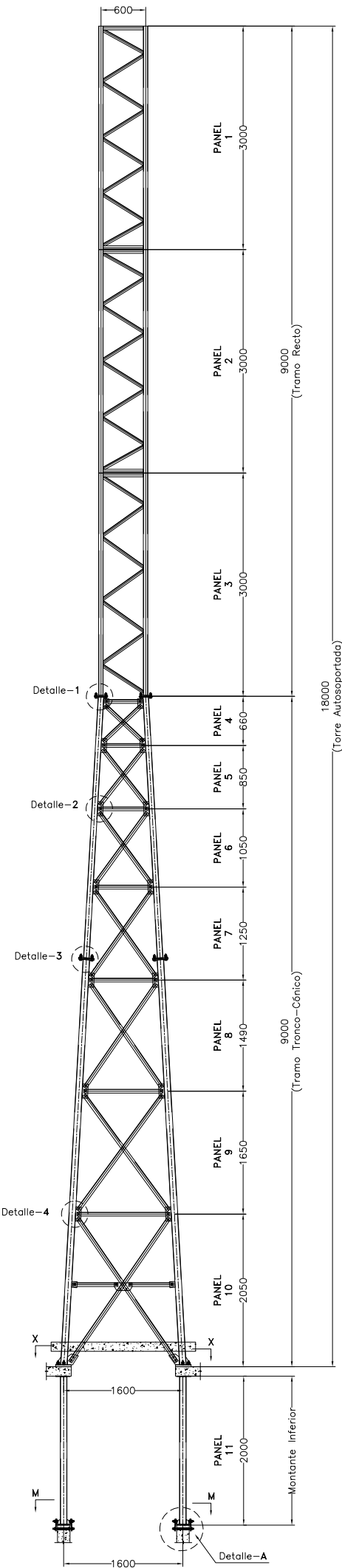

ELEVACION  
TORRE AUTOSOPORTADA h=18m  
ESC 1:75

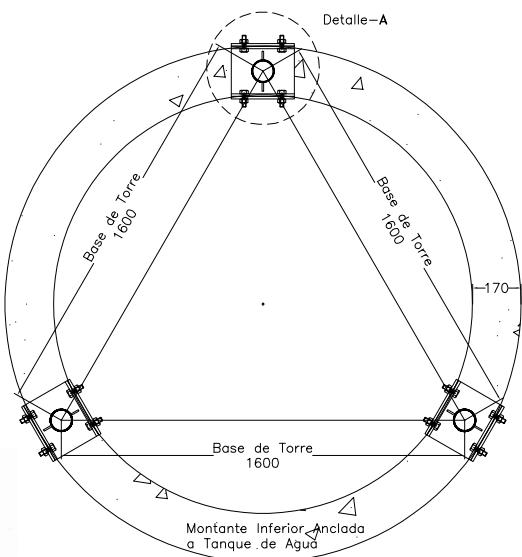

SECCIÓN M-M  
BASE DE MONTANTE INFERIOR  
ESC 1:30

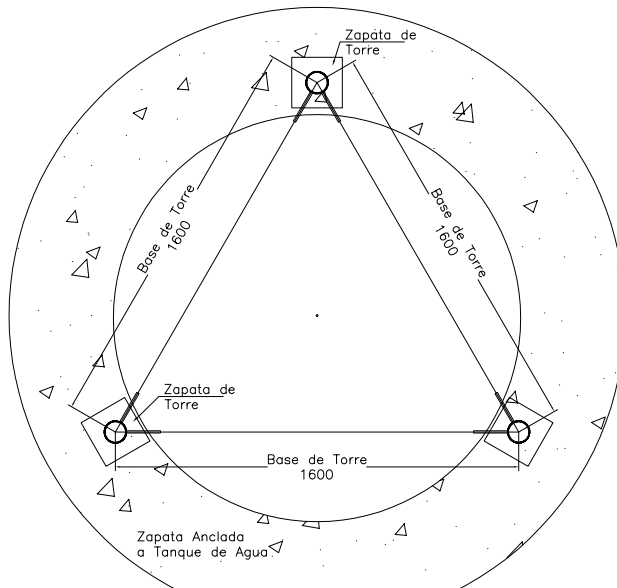

SECCIÓN X-X  
BASE DE TORRE  
ESC 1:30

RICARDO  
ALCAHUMAN MAMANI  
INGENIERO CIVIL  
Reg. CIP N° 148525

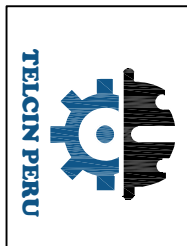

ESCALA:  
INDICADAS  
FECHA:  
OCTUBRE 2020

EM-01

NÚMERO DE LÁMINA:

PLANO:  
Torre Autosoportada  
h=18m  
RELEVAMIENTO

CLIENTE:  
SEDAPAL

ETAPA:

PROFESIONAL:  
RICARDO ALCAHUMAN M.  
CIP 148525

ESPECIALIDAD:  
ESTRUCTURAS

PROPIETARIO:  
SEDAPAL

| REVISADO POR: | FECHA |
|---------------|-------|
| 1             |       |
| 2             |       |
| 3             |       |
| 4             |       |

APROBADO POR:

